

RECTANGULAR 4.5m - SUA-LR45

Wind Rating: 33m/sec (120km/h)
 Rated when umbrella is fully erected.
 Umbrella weight: 85kg

Overall dimensions represent clearance dimensions for the complete umbrella.
 Membrane dimensions differ, depending on variations in tensioning and fabrication.
 Dimensions are in millimeters.

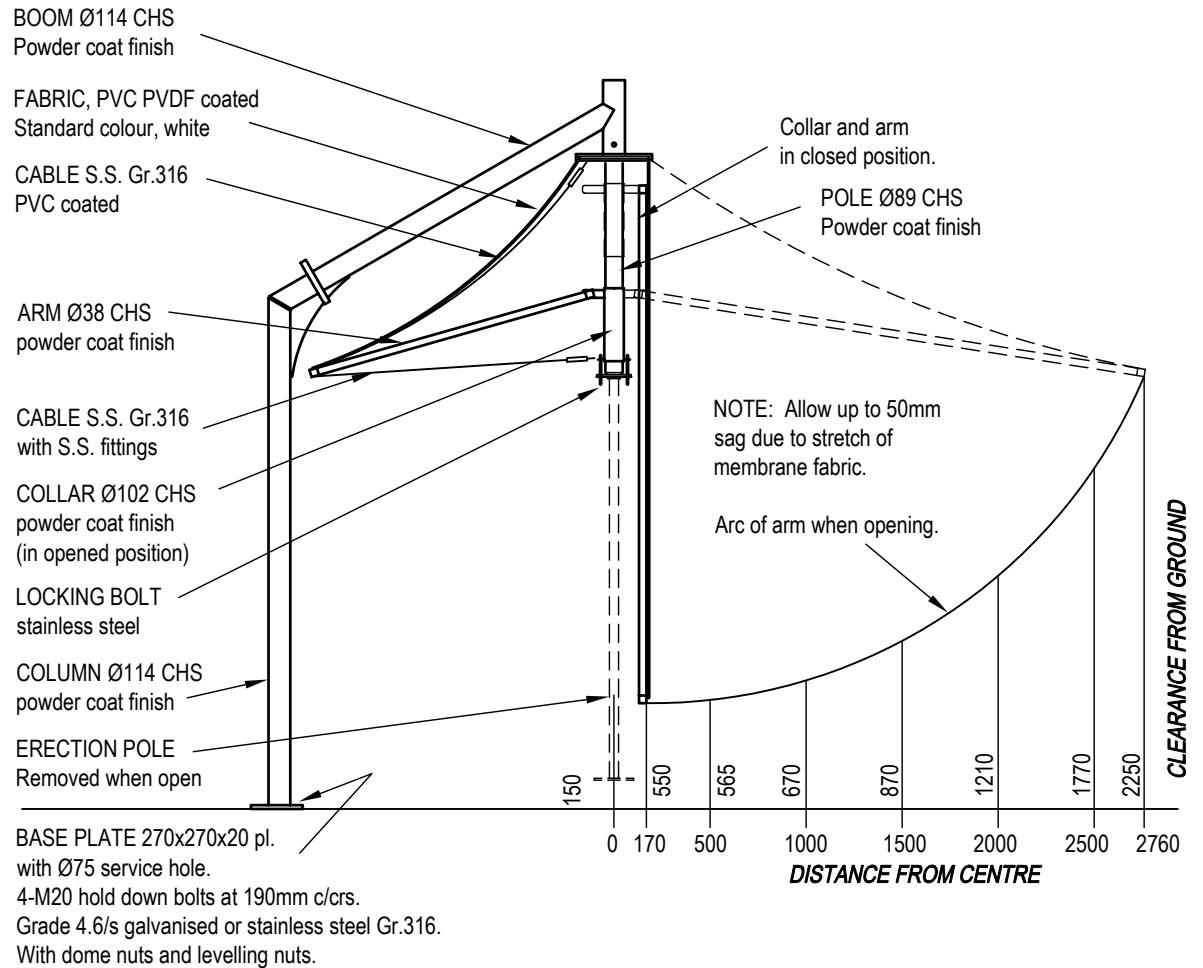
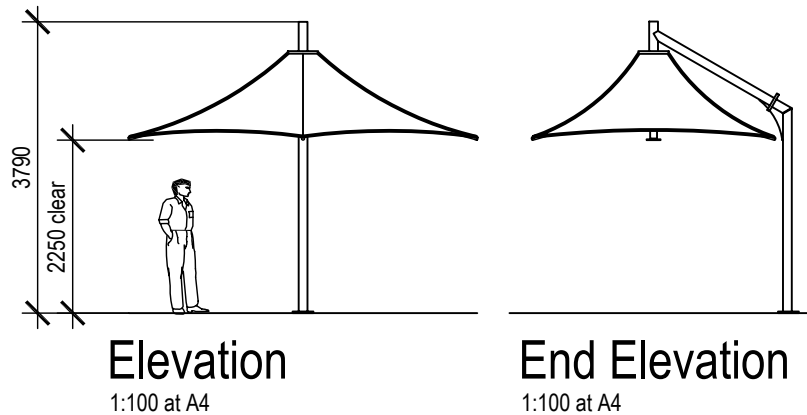
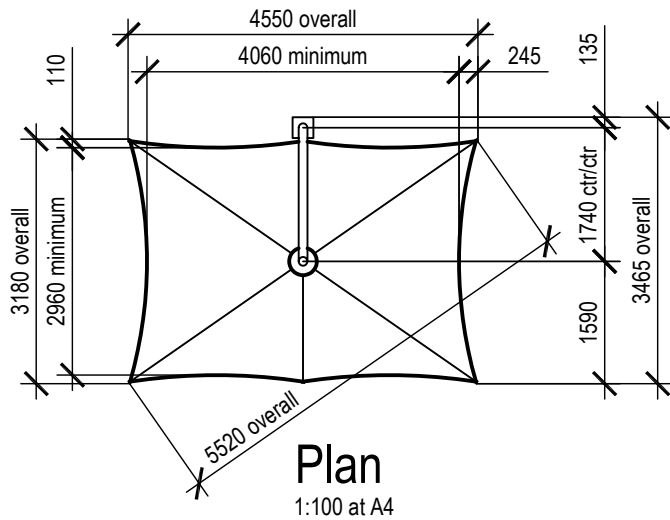

OPENED POSITION
 View square to boom

CLOSED POSITION
 View square to arm

**4.5m Side Support Rectangular Umbrella
 Model SUA-LR45**

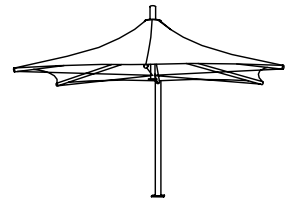

Side Support Series
 Model:SUA-LR45

Engineering Framing

**street
 umbrellas**
 Australia

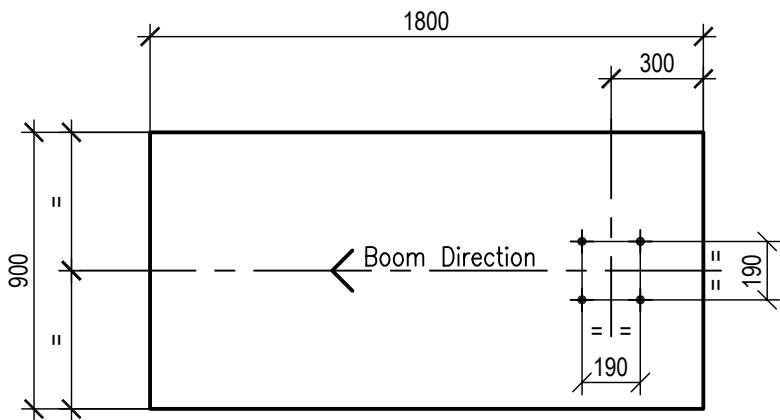

Plan

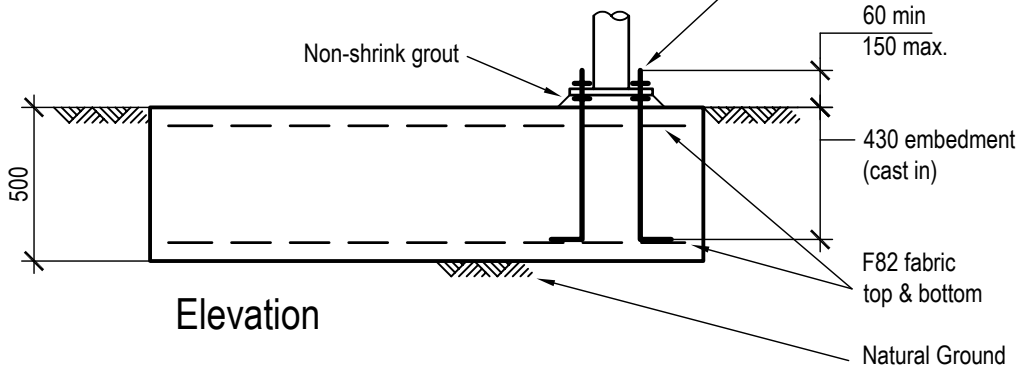

Elevation

SUA-LR45 Pad Footing

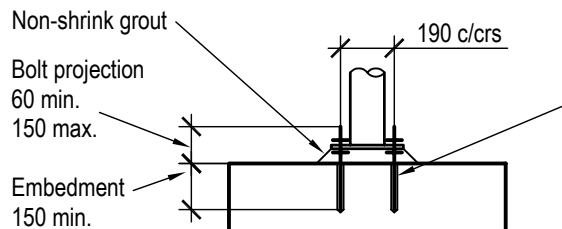

Chemical Anchor Detail

4-M20 H.D. bolts to be threaded rod grade 4.6/s hot dipped galvanised, or stainless steel Gr.316. Supplied with nuts, washers and levelling nuts. Chemical anchors, at 190 x 190 centres to be **Ramset Reo 502 (or 'Hilti HIT-RE 500')**, or engineer approved equivalent, and to be installed in accordance with the manufacturer's instructions.

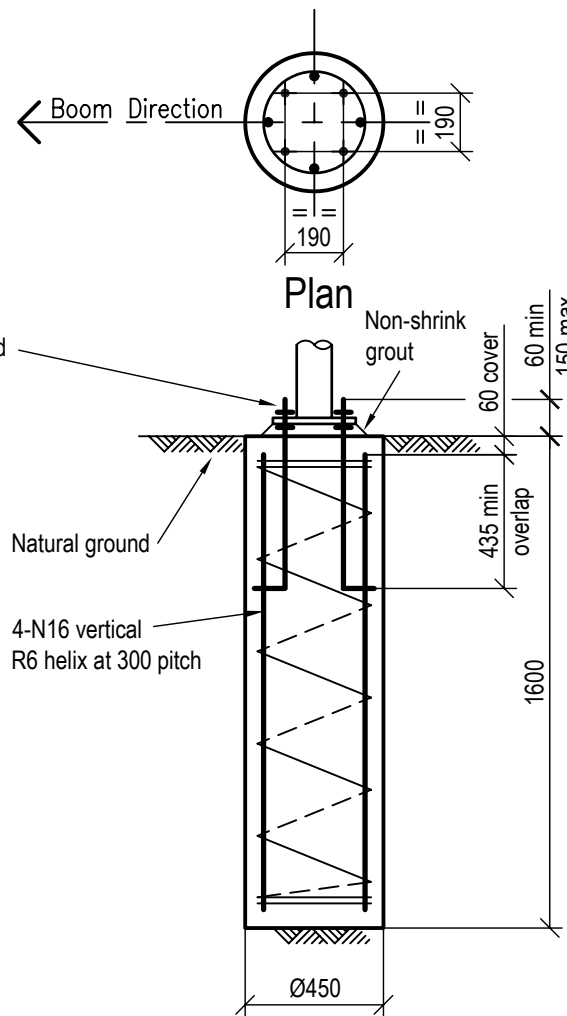

Elevation

SUA-LR45 Pier Footing

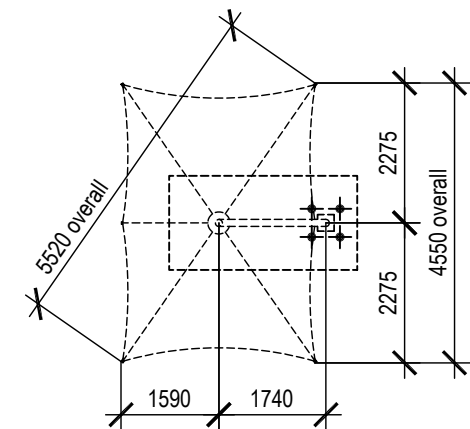

H.D. Bolt Layout Plan
Not to scale

Notes:

Design wind speed 33m/sec (W33)

Assumed soil conditions:

Pad - bearing capacity 100kPa

Pier - $c_u=50\text{kPa}$ (stiff clay)

Minimum 60mm cover to all reinforcement

Concrete grade to be N25

20mm aggregate size

Slump 65mm

Anchor bolt location tolerances per Australian Standard AS 4100-1990

- 3mm for anchor bolt centres within an anchor bolt group.
- 6mm for adjacent anchor bolt group centres.
- Maximum accumulation of 6mm per 30m not to exceed a total of 25mm.
- 6mm from anchor bolt group centre to column line centre.